

## Adding Exchange to iOS 11

1. Find the “Settings” App on your iPhone or iPad.

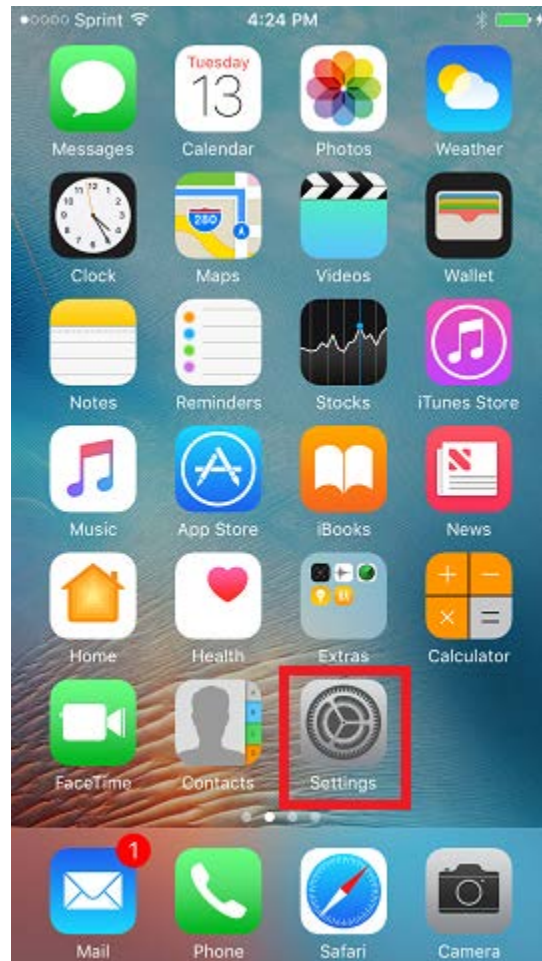

2. Scroll down to “Accounts & Passwords”. Tap this option.

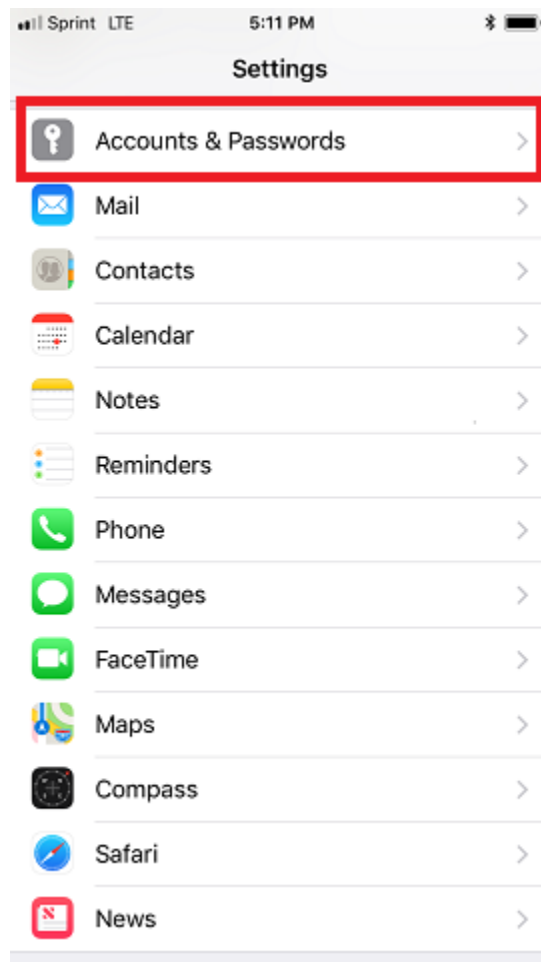

3. Tap “Add Account”

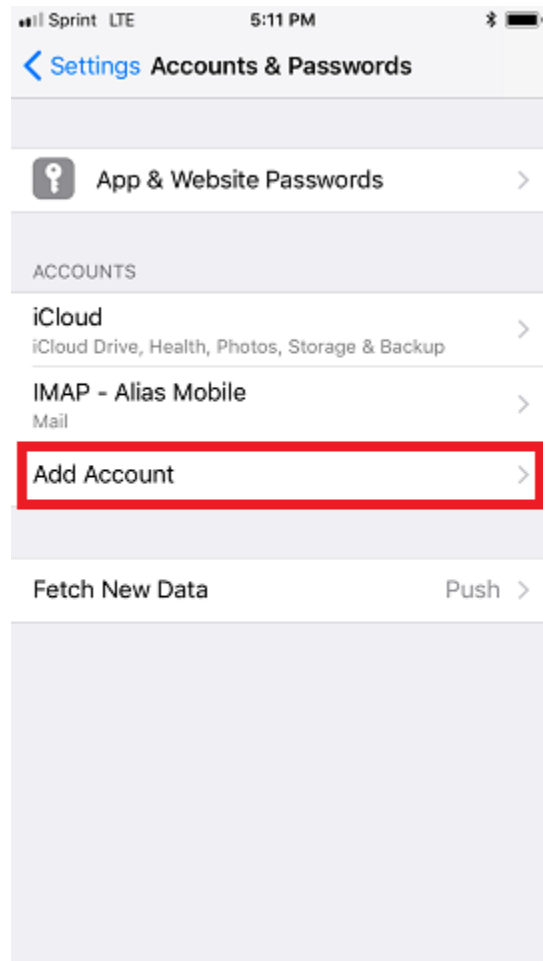

4. Tap the "Exchange" Option

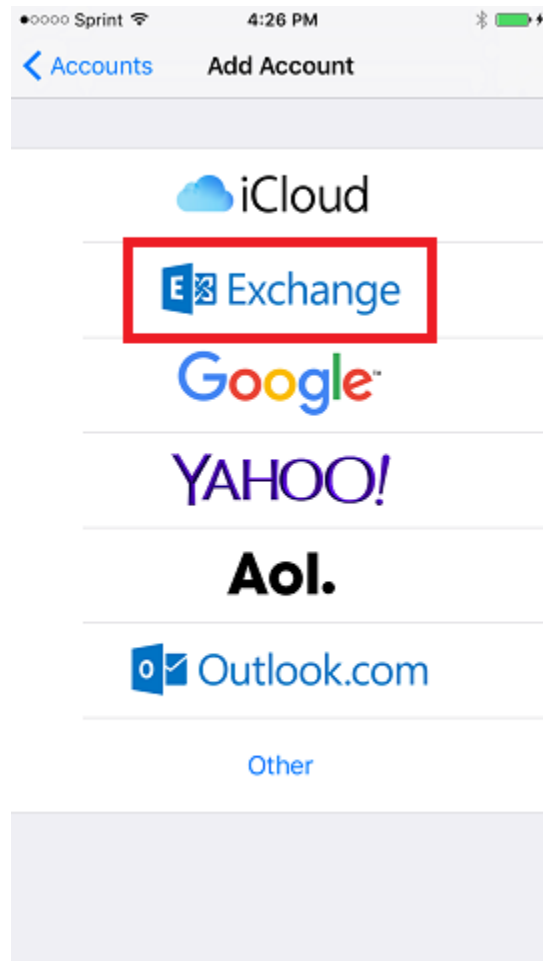

5. Enter your email in the "Email" space. Remember, this is your NETID followed by @exchange.tamu.edu. You may make the description whatever you want it to be. Tap Next.

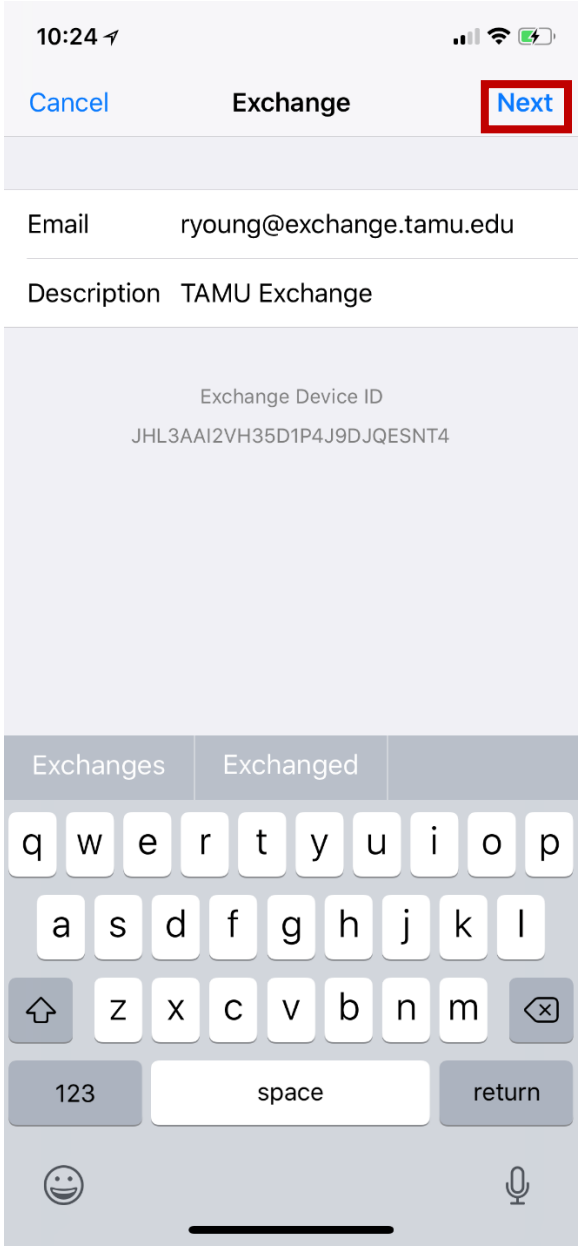

6. Tap the "Sign In" option.

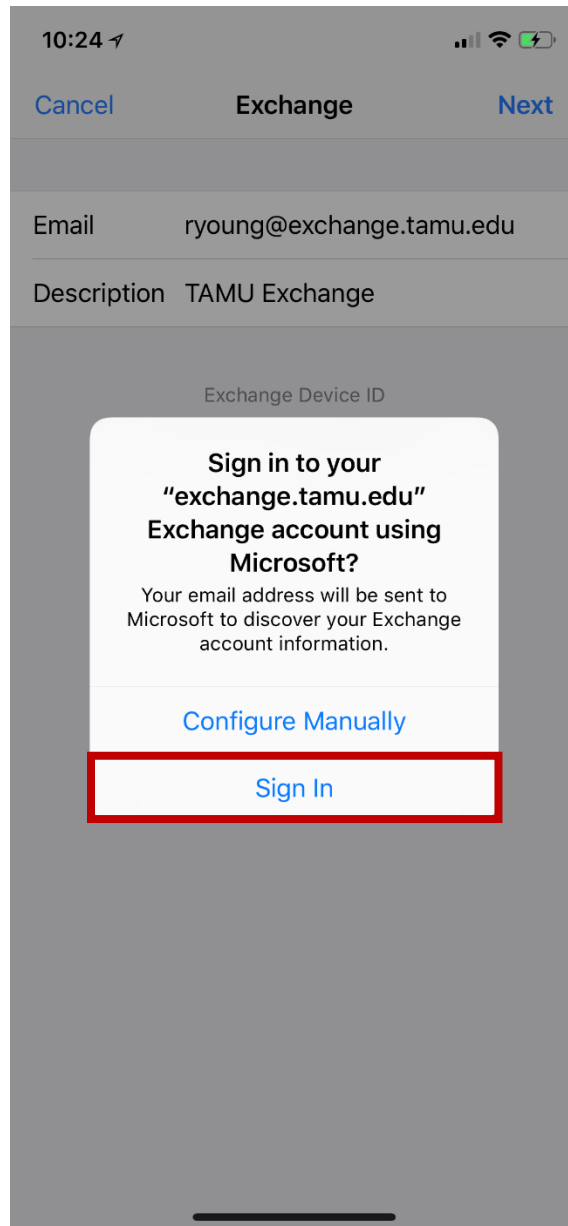

7. Input your NETID password in the password box, then tap Next.

10:25

Cancel Next

Email ryoung@exchange.tamu.edu

Password ●●●●●●●●●●●●

Description TAMU Exchange

Exchange Device ID  
JHL3AAI2VH35D1P4J9DJQESNT4

q w e r t y u i o p  
a s d f g h j k l  
↑ z x c v b n m ↵  
.?123 space return

8. In the “Sever” box, enter exchange.tamu.edu as it appears below. Then, in the “Username” field, type your NETID followed by @tamu.edu. Then, tape Next

10:26 100% [Signal] [Wi-Fi] [Battery]

Cancel Next

Email ryoung@exchange.tamu.edu

Server exchange.tamu.edu

Domain Optional

Username ryoung@tamu.edu

Password ●●●●●●●●●●●●●●●●

Description TAMU Exchange

q w e r t y u i o p  
a s d f g h j k l  
⌵ z x c v b n m ⌵  
123 space return  
😊 🎤



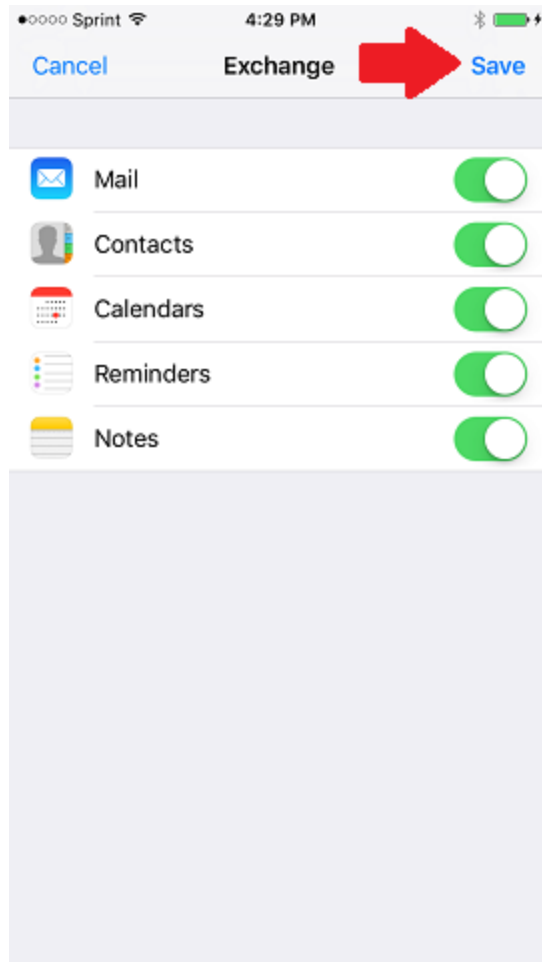

After tapping “Save”, your exchange setup for your iPhone or iPad will be completed.  
If you have any questions, please email [helpdesk@cvm.tamu.edu](mailto:helpdesk@cvm.tamu.edu).